

10-23

DEPARTMENT OF THE INTERIOR
NATIONAL PARK SERVICE
NATIONAL MONUMENTS NATIONAL PARK

FILE NO.
PART I.

NATIONAL MONUMENTS

"FOSILFEROUS REMAINS"

NEW MEXICO

LAST DATE ON TOP.

Plat
 showing boundaries
 of the proposed
 MASTODON NATIONAL MONUMENT

New Mexico

Township No. 20 N., Range No. 8 E.

Township No. 20 N., Range 9 E. *Township No.*

(From the unaccepted surveys
 of Group No. 92, as survey-
 in 1920.

Wm B Douglass
 William Boone Douglass,
 U.S. Cadastral Engineer.

D & R G. R. R.
Rio Grande

Espanola

Santa Cruz

Santa Cruz Grant.

Rio Santa Cruz

Co. Los Alaride

12
 West 23.17

13
 West 6.56

West 82.06

Rio Seca

As amended by Mr. Douglass
 because of area of culti-
 vated land therein

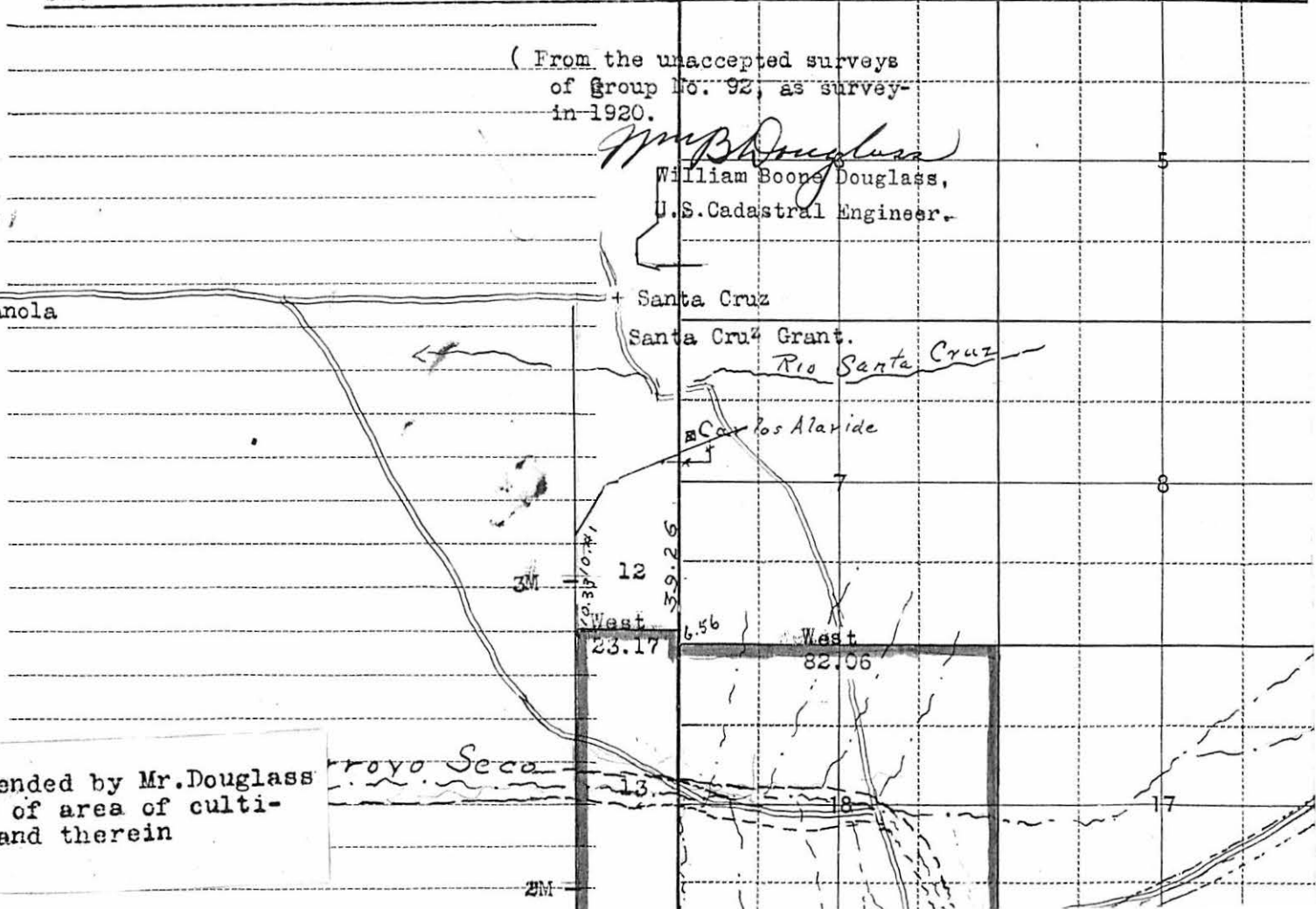

Santa Clara Pueblo Grant

(Note.-- The Santa Clara Pueblo grant is six miles square; its west boundary forms a part of the east boundary of the proposed National Park of the Cliff Cities. All of these Indian Pueblos are considered part of the national park, and 1M one of its most interesting features.)

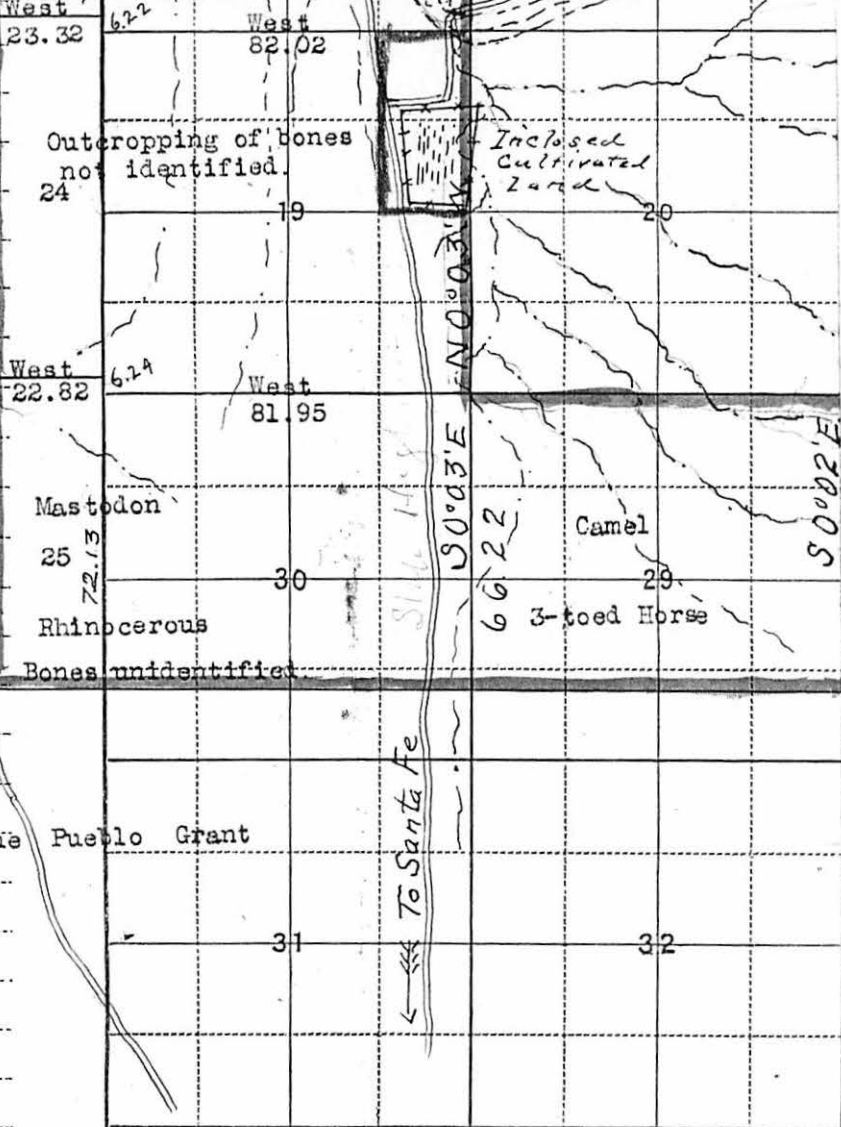

San Ildefonso Pueblo Grant

Pojoaque Pueblo Grant

Under the second section of the act of March 3, 1883, authorizing a charge to be made for plats or diagrams, the fees for the

- For a township diagram showing entered land only.....
- For a township plat showing form of entries, names of claimants, and character of entries.....
- For a township plat showing form of entries, names of claimants, character of entry, and number.....
- For a township plat showing form of entries, names of claimants, character of entry, number, and date of filing or entry, together with topography, etc.....

There is no legal authority for registers and receivers to charge or receive a fee of 25 cents for plats or diagrams of a section township.

NOTE.—Purchasers of township diagrams at a cost of one dollar each are entitled to definite information as to whether each and every smallest legal subdivision within the township which is not vacant, leaving the vacant tracts unmarked. The character of the entries thus checked off need not be shown.

590 B.

Range No. _____ Mer. _____

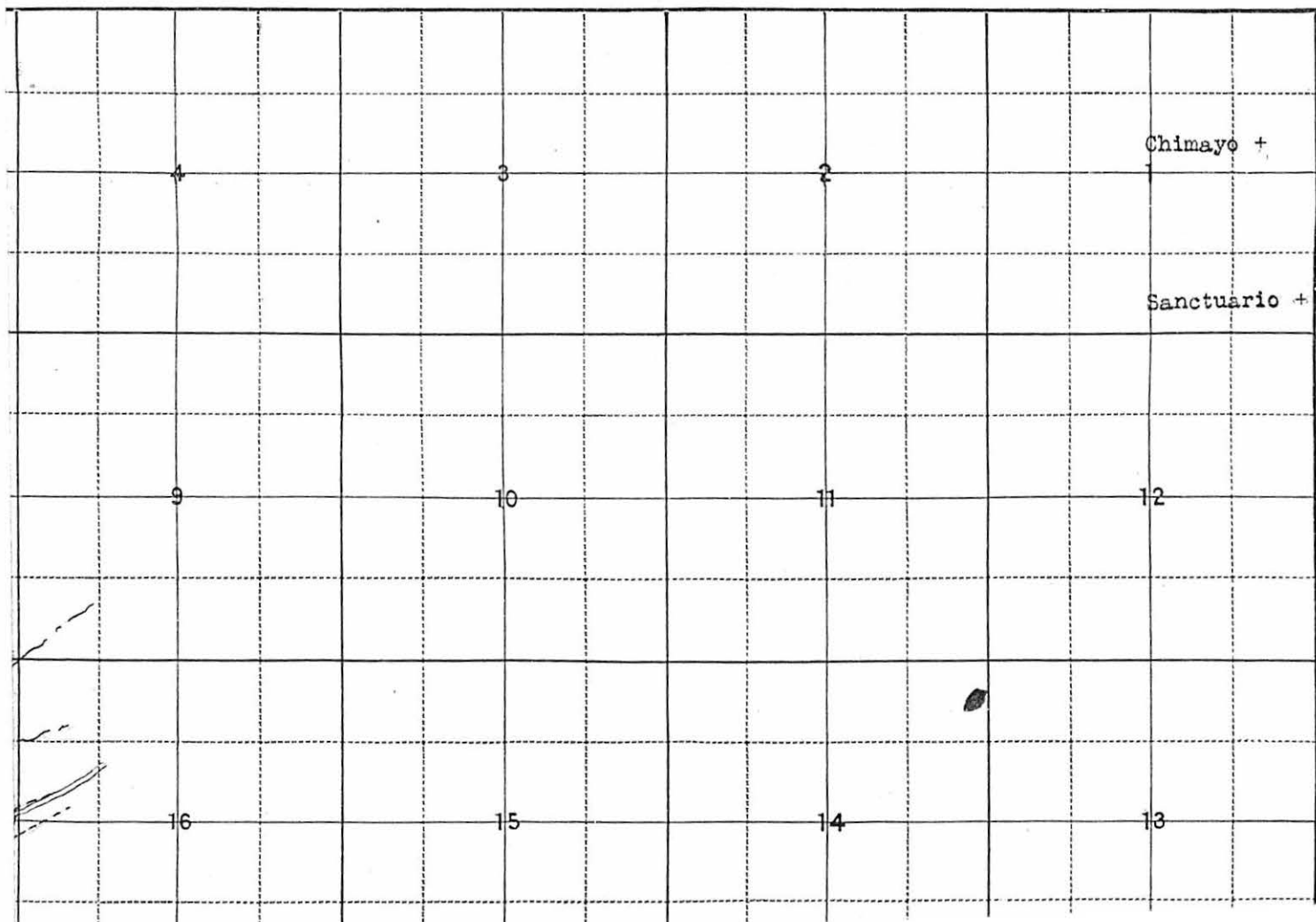

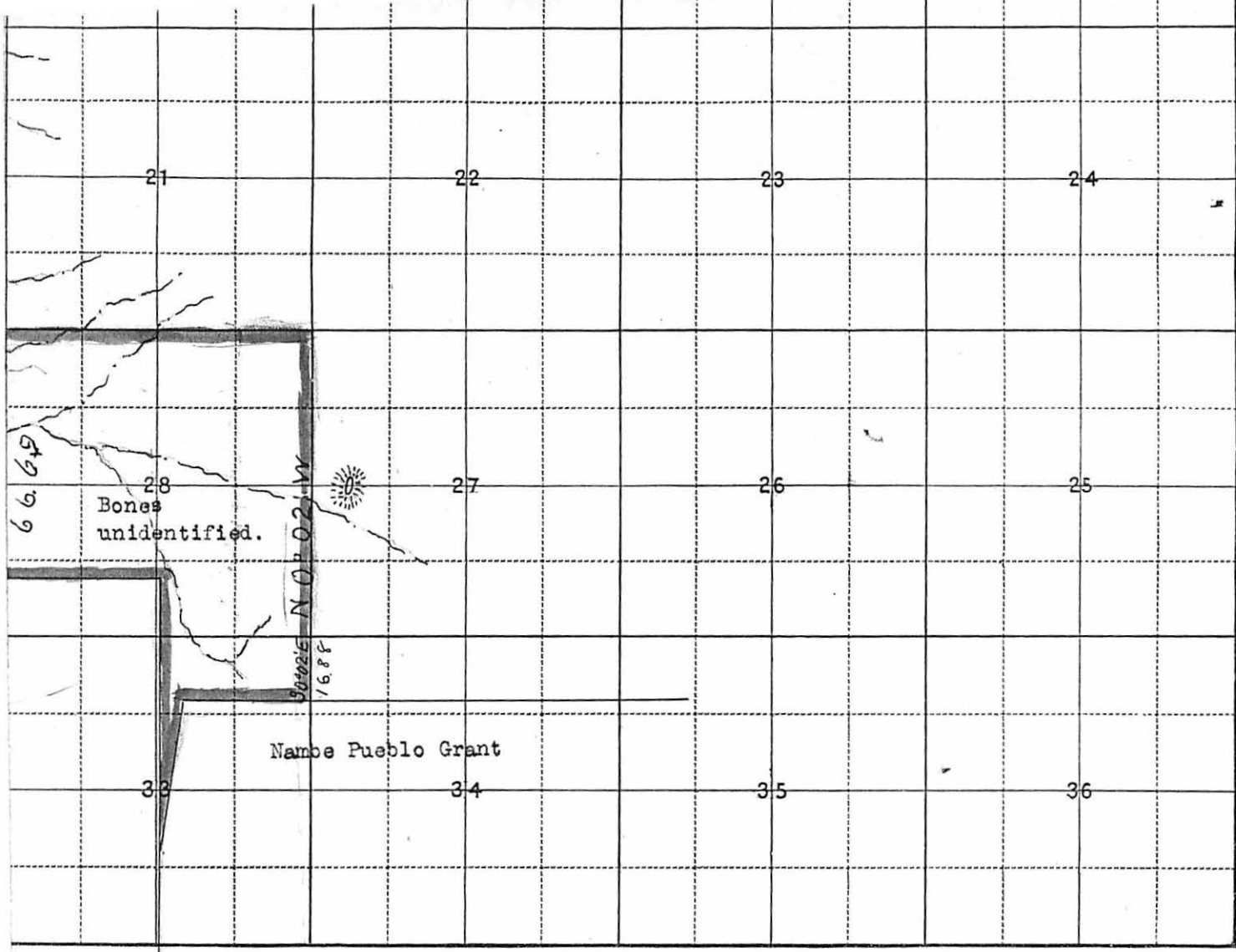

same are fixed as follows:

- \$1.00
- 2.00
- 3.00
- 4.00

n or a part of a section of a

ision or lot is vacant public land.
 X, every lot or smallest legal sub-

Scale 40 Chains to an Inch.

True Meridian.

DEPARTMENT OF THE INTERIOR,

GENERAL LAND OFFICE.

Washington, Feb. 14, 1921

The Honorable Commissioner,
General Land Office,
Washington, D.C.

RECEIVED
FEB 24 1921
G.L.O.



Sir:

In the execution of the surveys of Group No. 92, New Mexico, last September, I discovered a remarkable fossiliferous area, from which I brought specimens, as identified by the Smithsonian Institution, as follows:

<u>Name</u>	<u>Technical name</u>	<u>Specimen submitted.</u>
Mastodon	Trilophodon	Tooth ✓
Camel	Procamelus	Toe bone
Rhinoceros	Aphelos	Lower jaw.
Horse, three-toed	Merychippus	End of scapula.

Handwritten mark resembling the letter 'E'.

There were other specimens submitted not yet identified. These were of course picked up on the surface, without search or excavation, and seemingly give promise of a rich field of fossils that should not pass out of governmental control.

You will note also, by examining the inclosed map, that the fossiliferous area almost borders on the proposed national park of the Cliff Cities, being separated only by the Santa Clara Pueblo grant. These Indian Pueblo grants, bordering the proposed national park, are in effect part of the park, and one of its most attractive features. Thus these remarkable fossils are really of the national park area.

In reply to an inquiry, Dr. J.W.Gidley, palaeontologist of the U.S.National Museum, writes:

"Replying to your inquiry regarding the desirability of having the fossiliferous area withdrawn from settlement pending an investigation, I would say that it would be desirable if there was any certainty of this investigation being undertaken in the near future."

An effort is now being made to provide for such an investigation, in view of which I respectfully recommend its withdrawal from settlement as "The Proposed Mastodon National Monument". Its area would embrace fractional sections ~~18, 19, 28, 29, 30 & 33~~, 13, 24, and 25, T. 20 N., R. 8 E.; and Secs 18, 19, 28, 29, 30 & 33, T. 20 N., R. 9 E. The land is "bad-land" without agricultural possibilities. The proposed national park of the Cliff Cities will be created beyond all doubt, and the nearness of the fossiliferous area will give it great popular interest.

Copy of map furnished to Mr. H. ... 12-22-21

Very respectfully,

Handwritten signature: Wm B Douglass

William Boone Douglass,

U.S. Cadastral Engineer,

LY PLEASE REFER TO 971057 "FS" FSH

1 x

Incs.

DEPARTMENT OF THE INTERIOR

GENERAL LAND OFFICE

WASHINGTON

February 25, 1921

ADDRESS ONLY THE COMMISSIONER OF THE GENERAL LAND OFFICE

RECEIVED
FEB 26 1921
MAILS AND FILES
DEPT. OF THE INTERIOR

The Director

of the Park Service.

My dear Mr. Mather:

I transmit herewith for your consideration and such action as you may deem proper, recommendation of Mr. William B. Douglass, one of our surveyors, for withdrawal of certain lands in Northern New Mexico, containing remarkable fossiliferous remains, pending investigation to determine the advisability of reserving the lands for national monument purposes, together with accompanying diagrams.

These lands are not now subject to filing or entry under the public land laws, as, while the surveys have been executed in the field, the returns have not as yet been received or accepted.

Very respectfully,

[Handwritten Signature]
Commissioner.

2-21 MM

[Handwritten initials]

Enclosure



SMITHSONIAN INSTITUTION

Washington, U.S.A.

ALL CORRESPONDENCE
SHOULD BE ADDRESSED
TO THE SECRETARY

OFFICE
UNITED STATES NATIONAL MUSEUM
INTERNATIONAL EXCHANGES
BUREAU OF AMERICAN ETHNOLOGY
NATIONAL ZOOLOGICAL PARK
ASTROPHYSICAL OBSERVATORY
INTERNATIONAL CATALOGUE OF
SCIENTIFIC LITERATURE



March 22 1921

Dear Sir:-

Referring to your letter of March 10, with reference to the recommendation of Mr. Wm. B. Douglass, for the withdrawal of certain lands in northern New Mexico, containing remarkable fossiliferous remains for permanent preservation as a national monument, I beg to say that the proposition seems to be a most excellent one and the National Museum is glad to cooperate in the matter. Mr. Charles W. Gilmore, Associate Curator of Paleontology, has been directed to visit the locality as soon as practicable and will call upon you before leaving for the west. In compliance with your request the recommendation of Mr. Douglass and the plat showing the boundaries of the proposed monument are returned herewith.

Very truly yours,

Secretary.

Mr. Demaray

Mr. Stephen T. Mather,
Director, National Park Service,
Department of the Interior,
Washington, D.C.

lp

DEPARTMENT OF THE INTERIOR
NATIONAL PARK SERVICE
WASHINGTON

March 25, 1921.

Dear Mr. Spry:

Replying to the letter from your Office of February 25, 971057 "PS" PSH, transmitting for our consideration recommendation of Mr. William B. Douglass, one of your surveyors, that certain lands in northern New Mexico, containing remarkable fossiliferous remains, be temporarily withdrawn, pending investigation to determine the feasibility of reserving lands for national monument purposes, we have to advise you that we have taken up the question of having an investigation made of this area by the Smithsonian Institution, and we are in receipt of a letter from Dr. Walcott in which he states that the National Museum is very glad to cooperate in the investigation and that one of their scientists has been asked to visit the locality and report thereon. We understand that this investigation will be made in the near future, and, as your letter of February 25 stated that the lands involved are not now subject to filing or entry under the public land laws, as, while the surveys have been executed in the field, the returns have not yet been received or accepted, therefore, it does not seem to me necessary to ask for the withdrawal of these lands. It is requested though that before the surveys are accepted that this Service be notified and then if we have not received the report from the National Museum we could ask for a temporary withdrawal. We appreciate your courtesy in bringing this matter to our attention.

Cordially yours,

Arno B. Cammerer
Acting Director.

Hon. Wm. B. Spry, Commissioner,
The General Land Office.

AED:FBO

*This is for
discovery and
from the letter
of Mar 28 covers
the situation*

Mail Mts

DEPARTMENT OF THE INTERIOR
NATIONAL PARK SERVICE
WASHINGTON

March 25, 1921.

Dear Dr. Walcott:

We have your letter of March 22, advising us that the National Museum is very glad to cooperate in investigating certain lands in northern New Mexico, reported to contain remarkable fossiliferous remains, and that Mr. Charles W. Gilmore, Associate Curator of Paleontology, has been directed to visit the locality as soon as practicable. We will be very glad indeed to have Mr. Gilmore call upon us before he leaves for the West, and we want to express to you our sincere appreciation of the fine cooperation you have always offered this Service.

Cordially yours,

(SGD.) ARNO B. CAMMERER

Arno B. Cammerer
Acting Director.

card
Dr. Charles D. Walcott, Sec.,
Smithsonian Institution,
Washington, D. C.

AED:FBO

*NOTE
Fossiliferous Remains
New Mexico*

DEPARTMENT OF THE INTERIOR
NATIONAL PARK SERVICE
WASHINGTON

March 28, 1921.

Dear Mr. Spry:

Replying further to your letter of February 25, 971057 "FB" FHS, regarding the recommendation of Mr. William B. Douglass, one of your surveyors, that certain lands in northern New Mexico, containing remarkable fossiliferous remains be temporarily withdrawn, pending investigation to determine the advisability of reserving these lands for national monument purposes, we have to advise you that we concur in this recommendation and request that the said lands be temporarily withdrawn from settlement under authority of the act of Congress approved June 25, 1910, pending said investigation for which we have arranged with the National Museum to be made at an early date. It is requested that your Office prepare an Executive Order withdrawing the lands, which are the public lands in Secs. 18, 19, 28, 29, 30 and 33 in T. 20 N., R. 9 E. and the public lands in Secs. 13, 24, and 25 in T. 20 N., R. 6 E. of N.M.S. & M. We appreciate your courtesy in bringing this matter to our attention.

Cordially yours,

Arno B. Cammerer
Acting Director.

ASD
Hon. Wm. S. Spry, Commissioner,
General Land Office.

AED:FEC

M.M.
D. M. ...

EXECUTIVE ORDER

-----oOo-----

NEW MEXICO

Under authority of the Act of Congress approved June 25, 1910 (36 Stat., 847), as amended by the Act of August 24, 1912 (37 Stat., 497), it is hereby ordered that the following described unsurveyed area in New Mexico be, and the same is hereby, temporarily withdrawn subject to the conditions, provisions and limitations of said Acts, for classification and pending determination as to the advisability of reserving said land for National Monument purposes: Provided, That this withdrawal shall not prevent or preclude the use of these lands, or any of them, for grazing or other analogous purposes temporary in character and not inconsistent with the purpose of this order.

New Mexico Principal Meridian

In T. 20 N., R. 8 E., those portions of Secs. 13, 24 and 25 not in private grants;

In T. 20 N., R. 9 E., Sec. 18, W $\frac{1}{2}$ NE $\frac{1}{4}$, NW $\frac{1}{4}$, and S $\frac{1}{2}$ Sec. 19, and those portions of Secs. 28, 29, 30 and 33 not in private grants.

(Signed) WARREN G. HARDING

THE WHITE HOUSE,

May 3, 1921. ✓

W 3450

Aug 31, 1921
Rec. of Smith
- to President
the Department
of the Interior

Copy
transmitted to
Smithsonian
Institution
by
D.M.C.

W.G.H.

*Mail Ms.
Doubtless in Paris*

DEPARTMENT OF THE INTERIOR

NATIONAL PARK SERVICE

WASHINGTON

April 18, 1921.

Dear Mr. Gilmore:

Inclosed is a copy of Mr. Wm. B. Douglass' recommendations to the Commissioner of the General Land Office, re the proposed National Monument, New Mexico.

I understand you obtained a copy of Mr. Douglass' map when you were at this office several days ago, and therefore I am not sending a copy of the map to you.

If there is anything further I can do for you I would be indeed glad to have you call on me.

Cordially yours,



Editor.

Mr. Charles W. Gilmore,
Associate Curator, of Paleontology,
Smithsonian Institute,
Washington, D.C.

Ins. 3557.

AED:FLK.

Enclosure

Mr. Mather



SMITHSONIAN INSTITUTION

Washington, U.S.A.

ALL CORRESPONDENCE
SHOULD BE ADDRESSED
TO THE SECRETARY



UNITED STATES NATIONAL MUSEUM
INTERNATIONAL EXCHANGES
BUREAU OF AMERICAN ETHNOLOGY
NATIONAL ZOOLOGICAL PARK
ASTROPHYSICAL OBSERVATORY
INTERNATIONAL CATALOGUE OF
SCIENTIFIC LITERATURE

June 9 1921

Dear Sir:-

Referring to previous correspondence, and particularly to your letter of March 10, I beg to say that Mr. Charles W. Gilmore, Associate Curator of Paleontology in the National Museum, has visited the area temporarily withdrawn from settlement known as "The Proposed Mastodon National Monument." In view of his report, a copy of which is enclosed, I would recommend that the order withholding the area from settlement be rescinded.

Very truly yours,

Secretary.

Mr. Stephen T. Mather,
Director, National Park Service,
Department of the Interior,
Washington,
D.C.

lp

Results of the Investigation.

The proposed Mastodon National Monument under investigation embraces fractional sections 13, 24, and 25, T 20 N, R 8 E, and sections 18, 19, 28, 29, 30, and 33, T 11, R 9 E - something over five square miles of territory.

Realizing that my stay in the field would be limited to a few days, it was planned from the first to make as complete a reconnaissance of the area as the time at my disposal would permit. This hurried survey of the field was made on horse back, stops being made only here and there at favorable localities to prospect for fossils. In this way the whole area of the proposed monument was covered. Surface indications in the form of scattered and broken pieces of fossil bones were frequently found, though in no instance was I successful in locating within the boundaries prescribed any fossil specimens worthy of special mention.

That good specimens are to be found if sufficiently searched for is indicated by the discovery in the contiguous "bad lands" of the Santa Clara Pueblo Grant of a well preserved skull, lower jaws, and other bones of a small rhinoceros (see map), not yet identified, and in the Pojuaque Pueblo Grant of foot, limb, and other bones of an extinct camel. While these were the only discoveries made where the source of the surface indications ("float") was successfully traced into the undisturbed strata with the fossil bones in situ, the frequent occurrence of surface fragments, in a "bad land" area of many square miles in extent, with many clean exposures free of vegetation, makes this a most promising region for the recovery of fossil vertebrate remains. Moreover, the preservation of the fossil bone is usually excellent, and in the few instances where the bones were found in place, the soft, sandy character of the matrix makes the work of excavation favorable to obtaining the most delicate structures intact.

The beds of the Santa Fe marls on the western side of this general area rise from the mile or more of flat agricultural land on the east bank of the Rio Grande in a series of sharp, parallel ridges having a north and south trend, with narrow valleys between. The beds have nearly a 45° dip to the west. They are made up of alternately soft and hard sandstones, some of the layers being massive and of considerable thickness. The fossil specimens found in place occurred in the softer bands, the camel specimen in a very soft sand layer, the rhinoceros in a consolidated sandy clay, the bones being wholly or partially inclosed by a hard, concretionary sandstone. In places the "bad lands" were eroded into rounded and picturesquely formed masses of rock.

only of rhinoceros and camel bones

The "bad land" area is not confined to the proposed monument, but extends westward to within a mile or more of the Rio Grande river which cuts through the eastern part of the Santa Clara Pueblo Grant, and also to the south and west into the San Ildefonso, Pojuague, and Nambe Pueblo Grants, all of which border on the monument area. In fact, the most favorable looking ground for the collecting of fossils, consisting of low, rounded bad lands, absolutely clean of vegetation and of several acres in extent, was observed in the northern part of the Pojuague Pueblo Grant. These bad lands also extend eastward for several miles, especially favorable looking territory being noted along the southern side of the Santa Cruz River. I was informed by Mr. Compton that the land survey party of Mr. W. B. Douglass also found fossil bones in these bad lands.

Recommendations.

Since the many square miles of "bad lands" surrounding the reserved area are equally fossiliferous and in places present much more favorable territory for the recovery of fossil remains than any observed within the boundaries of the monument, and also since the greater part of these surrounding areas lie within Pueblo Grants over which Federal control has been relinquished, there would be no advantage in retaining governmental control of so small a part of the area as is represented in the proposed monument.

I would, therefore, respectfully recommend that the order for the temporary withdrawal of the area known as "The Proposed Mastodon National Monument" from settlement be rescinded.

M. M. Fossiliferous

DEPARTMENT OF THE INTERIOR
NATIONAL PARK SERVICE
WASHINGTON

June 15, 1921.

Dear Mr. Spzy:

Reference is made to the letter from your Office of February 25, 971057 "FS" PSH, and the reply from this Service under date of March 28, 1921 relative to certain lands in northern New Mexico, containing fossiliferous remains temporarily withdrawn by Executive Order of May 3, 1921, pending investigation to determine the advisability of reserving these lands for national monument purposes.

Inclosed are copies of correspondence from Mr. Charles D. Walcott, Secretary of the Smithsonian Institution, relative to the investigation of this area. The Park Service concurs in the recommendation therein and requests that your Office prepare an order revoking the Executive Order of May 3, 1921.

Cordially yours,

Arno B. Cammerer
Acting Director.

ASD

Hon. Wm. S. Spzy, Commissioner,

General Land Office.

Enclosure 7160.

ABD:FB

M. M.
Fossiliferous

DEPARTMENT OF THE INTERIOR

NATIONAL PARK SERVICE

WASHINGTON

June 15, 1921.

Dear Dr. Walcott:

This will acknowledge receipt of your letter of June 9, inclosing a report of investigation by Mr. Charles W. Gilmore, Associate Curator of Paleontology in the National Museum, of the area temporarily withdrawn from settlement, known as "The Proposed Mastodon National Monument." In view of his report we heartily concur in your recommendation that the order withdrawing the area from settlement be rescinded, and we have this day requested the General Land Office to prepare an order revoking the Executive Order of May 3, 1921.

Let me express to you the appreciation of this Service in the cooperation which the Smithsonian Institution has given in the investigation of this area.

Cordially yours,

(Sgd) ARNO B. CAMMERER

Arno B. Cammerer
Acting Director.

Dr. C. D. Walcott, Secretary,
Smithsonian Institution,
Washington, D. C.

AED:FBC

AM

Mr. Finney,
Washington
Natl. Parks

NATIONAL PARK SERVICE
RECEIVED
THE WHITE HOUSE SEP 2 1921
WASHINGTON AND FILES
DEPT. OF THE INTERIOR

DEPT. OF THE INTERIOR
RECEIVED
SEP 2 1921
TO NATIONAL PARKS
BY DIRECTOR OF THE INTERIOR

August 31, 1921.

Referring to your letter of August 31st, I beg leave to advise you that the President signed and sent to the State Department today the Executive Order revoking Executive Order of May 3, 1921, as recommended by the Acting Director of the National Park Service.

Sincerely yours,

Georg Christian Jr
Secretary to the President.

Hon. E. C. Finney,
Acting Secretary of the Interior.

FIRST ASST SECY.
RECEIVED
SEP 1 1921
DEPARTMENT OF THE INTERIOR

Wastodon fossils
in Arizona
file = 403

BS

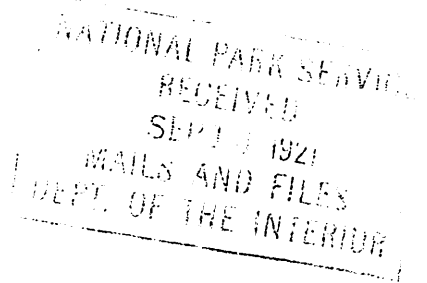

Executive Order

NEW MEXICO

It is hereby ordered that Executive Order of May 3, 1921, (3,450), temporarily withdrawing the following described lands in New Mexico for classification and pending determination as to the advisability of reserving said lands for National Monument purposes, be revoked:

New Mexico Principal Meridian

In T. 20 N., R. 8 E., those portions of Secs. 13, 24 and 25, not in private grants;

In T. 20 N., R. 9 E., Sec. 18, W $\frac{1}{2}$ NE $\frac{1}{4}$, NW $\frac{1}{4}$ and S $\frac{1}{2}$ Sec. 19, and those portions of Secs. 28, 29, 30 and 33, not in private grants.

WARREN G HARDING

THE WHITE HOUSE,

August 31, 1921.

[No. 3542.]

ADDRESS ONLY
THE DIRECTOR, NATIONAL PARK SERVICE
WASHINGTON, D. C.

UNITED STATES
DEPARTMENT OF THE INTERIOR
NATIONAL PARK SERVICE
WASHINGTON

December 27, 1928.

Memorandum for Mr. Cammerer:

Doctor Merriam called up today in reference to a newspaper article and editorial which recently appeared in the Washington Star concerning discoveries in New Mexico made by scientists of the University of California. It seems that the article and editorial stated that the region explored by these men contained fossil remains of life ^{from} earliest times up to the present, a span of about 75,000,000 years. It appears the editorial stated that such a rich area in fossil remains should be under the protection of the federal Government.

Doctor Merriam called up to say that we shouldn't be excited about this article and editorial as we already had in Grand Canyon, Zion and Bryce National Parks this exhibit of fossil remains which extended over a period of a thousand million to fifteen hundred million years, and that this was being written up by Doctor Merriam and Doctor White for the Grand Canyon educational work. Doctor Merriam said he called Doctor White and suggested that he write up a brief memorandum covering this and that Doctor White had promised to do so.

Demarey