

# Cat Island

National Wildlife Refuge  
Hunting and Fishing  
Regulations  
2005-2006

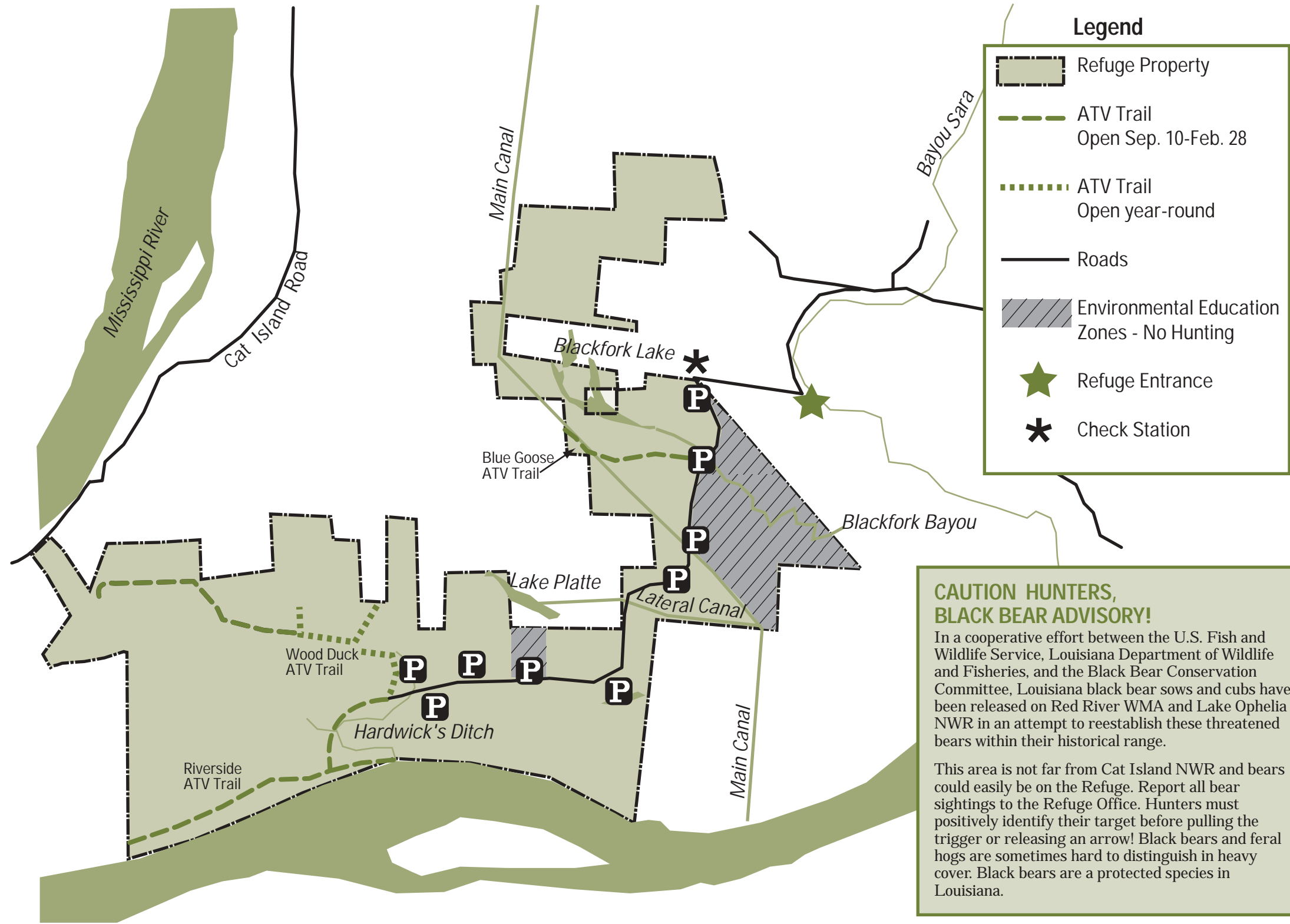

**CAUTION HUNTERS, BLACK BEAR ADVISORY!**

In a cooperative effort between the U.S. Fish and Wildlife Service, Louisiana Department of Wildlife and Fisheries, and the Black Bear Conservation Committee, Louisiana black bear sows and cubs have been released on Red River WMA and Lake Ophelia NWR in an attempt to reestablish these threatened bears within their historical range.

This area is not far from Cat Island NWR and bears could easily be on the Refuge. Report all bear sightings to the Refuge Office. Hunters must positively identify their target before pulling the trigger or releasing an arrow! Black bears and feral hogs are sometimes hard to distinguish in heavy cover. Black bears are a protected species in Louisiana.

Season Dates	Season Type	Specific Regulations
State Season	Squirrel	Closed during muzzleloader and gun deer hunts. Dogs permitted January 23, 2006 to end of State squirrel season.
State Season	Rabbit	Closed during muzzleloader and gun deer hunts. Dogs permitted January 23, 2006 to end of State rabbit season.
State Season	Deer-Archery	One, either-sex deer per day, closed during muzzleloader and gun deer quota hunts.
November 5-6, 2005	Deer-Muzzleloader	<b>Special Quota Permit Required</b> One, either-sex deer per hunt, hunter orange (hat and vest) required, hunters must check in and out at check station.
November 19-20, 2005	Deer-Gun	<b>Special Quota Permit Required</b> One, either-sex deer per hunt, hunter orange (hat and vest) required, hunters must check in and out at check station.
Tuesday, Thursday, Saturday and Sunday until noon during State waterfowl season	Waterfowl	Closed during muzzleloader and gun deer hunts. Boats, blinds, and decoys must be removed daily. Non-toxic shot only. Possession of lead shot prohibited.
State Season	Woodcock	Closed during muzzleloader and gun deer hunts. Non-toxic shot required.

Cat Island  
National Wildlife Refuge  
401 Island Road  
Marksville, Louisiana 71351  
318/253 4238

U.S. Fish & Wildlife Service  
1 800/344 WILD  
<http://southeast.fws.gov>  
<http://www.fws.gov/southeast/catisland>

July 2005



## The Refuge

Cat Island National Wildlife Refuge was established in 2000 primarily to conserve, restore, and manage native forested wetland habitats for migratory birds, aquatic resources, and endangered and threatened plants and animals. The refuge is located along the Mississippi River about 30 miles north of Baton Rouge, Louisiana. The habitat consists of bottomland hardwood forests and cypress/tupelo swamps, which are inundated by the Mississippi River each year. The refuge is known for its numerous old growth cypress trees, many of which are over 1,000 years old.

Access to the refuge is limited during late winter/spring due to nearly annual flooding by the Mississippi River. To assist refuge visitors, the refuge boundary is marked with white refuge boundary signs and yellow boundary paint. Markings are located at both eye level and up to about 15 feet high. It is the responsibility of the visitor to recognize these markings and to avoid trespassing onto private property adjacent to the refuge.

## General Regulations

Individuals utilizing the refuge are subject to inspections of permits, licenses, hunting equipment, bag limits, boats, vehicles, and their contents by refuge officers. To ensure your safety and enjoyment while visiting Cat Island, please take the time to become familiar with the following regulations.

Hunting and fishing regulations are designed to protect the sportsman as well as wildlife populations. The regulations below supplement the general regulations which govern hunting and fishing on national wildlife refuges as set forth in Title 50, Code of Federal Regulations. Hunting and fishing will be in accordance with applicable state regulations subject to the following regulations.

The refuge is open to public access between 4:00 am and one hour after legal sunset.

Special arrangements can be made to accommodate persons with bona fide disabilities by contacting the refuge office.

## Weapons and Ammunition

Firearms, archery tackle, and crossbows are permitted on the refuge only during designated refuge hunts.

Firearms carried in vehicles or boats must be unloaded AND encased or dismantled. Firearms carried on ATVs must be unloaded. Loaded is defined as shells in gun or caps on muzzleloader. Archery tackle and crossbows must be uncocked with arrow unnoocked from string.

Only .22 caliber or less rimfire rifles and shotguns are permitted except during the muzzleloader and gun deer hunts. Handguns are not permitted.

Possession of shot larger than that legal for waterfowl hunting is prohibited. Only non-toxic shot is permitted. Use or possession of lead shot is prohibited on the refuge.

## Exceptions

During quota gun and muzzleloader deer hunts, lead ammunition legal for taking deer may be used.

Small game, furbearers, raccoon, feral hogs, beaver, nutria, and coyotes may be hunted with .22 caliber or less rimfire lead ammunition during open seasons.

## Permits

An annual Special Recreational Activity Permit is now required for all hunters and fishermen 16-years of age and older, and for all terrain vehicle (ATV) use on the refuge. Permits are available for purchase everyday between the hours of 9:00 am to 5:00 pm at the West Feliciana Historical Society Museum and Tourist Information Center, located at 11757 Ferdinand Street, St. Francisville, LA. Permits may also be ordered by mail at the following address. Central LA Refuge Complex, 401 Island Road, Marksville, LA 71351, Attn: Cat Island Special Recreational Activity Permit

Request for permits by mail must include name, address, phone number, driver's license number and \$15.00 (money order or cashier's check made payable to U.S. Fish and Wildlife Service only: NO cash or personal checks accepted). Refuge permits authorize participation in all refuge hunting and fishing, except for quota muzzleloader and gun deer hunts. The permit must be signed and in your possession whenever hunting, fishing, or using an ATV on the refuge, and acknowledges your understanding of refuge regulations. An additional refuge lottery permit is required for quota deer hunts. Call 318/253 4238 for more information.

## To Apply for Quota Hunt Permits

Print or type your name, address, phone number, birth date, and drivers license number on a 3x5 index card or standard postcard. A \$5.00 application fee per **person** must be submitted with each entry (certified checks or money orders made payable to the U.S. Fish and Wildlife Service only). For example, if four people are in a group the fee is \$20.00.

On the 3x5 card, indicate the hunt (muzzleloader or gun) for which you are applying. A separate card must be filled out for each hunt. **Only one entry per person or group.** To apply as a group (maximum of five hunters per group), list required information for all applicants on the same card. You may apply for both hunts.

Mail completed cards to the Central LA Refuge Complex, 401 Island Road, Marksville, LA, 71351, Attn: Cat Island Quota Hunts. Applications must be received by close of business on August 31, 2005 for both muzzleloader and gun deer hunts. Duplicate, unclear or incomplete cards will not be considered. No faxed entries will be accepted.

Applicants will be selected via random drawing and will be notified by mid-September for both deer quota hunts. Selected individuals will be required to send a self-addressed, stamped envelope and cashier's check or money order for \$15.00 made payable to the U.S. Fish and Wildlife Service to receive a lottery permit.

Permits are non-transferrable and must be in the hunter's possession at all times while on the refuge during the permitted hunt. Only hunters with valid quota permits are allowed on the refuge during quota hunts.

## Motorized Vehicles

All licensed vehicles are restricted to roads that are delineated on refuge map. All-terrain vehicles (ATV's) are restricted to ATV trails only as delineated on the refuge map and as designated by ATV signs. ATVs (3 and 4-wheelers) are defined as an off-road vehicle with factory specifications not to exceed the following: weight-750 lbs., length-85", and width-48". ATV tires are restricted to those no larger than 25 X 12 with a maximum 1" lug height and a maximum allowable tire pressure of 7psi as indicated on the tire by the manufacturer.

ATV trails are open from September 10, 2005 through the last day of rabbit season (February 28, 2006). Exception: Portions of Wood Duck ATV Trail are open throughout the year for wildlife-dependent activities as indicated on refuge map.

ATVs are only allowed for wildlife-dependent activities. The maximum legal speed for any land vehicle is 25 mph.

## Specific Hunting Regulations

State bag limits apply unless otherwise specified. The only seasons open are those listed in this brochure.

## All hunters must sign in at refuge check station upon entering and leaving refuge.

Hunters may enter and exit the refuge from designated refuge parking areas only.

Hunting is permitted only in designated areas during dates shown in brochure. Possession of firearms or archery tackle is prohibited in areas posted as "No Hunting Zones."

Hunters under 16 years of age must possess proof of completion of an approved Hunter Safety Course and be accompanied (in sight and in normal voice contact) at all times by an adult 21 years old or older. Each adult must

have a refuge permit and can supervise only one youth during deer hunts and not more than two youths during all other hunts.

Harvest records are vital to the management of refuge wildlife resources. You must report your game harvest at the check station after each hunt.

Archery hunters (regardless of age) must possess proof of completion of the International Bowhunter Education Course.

All deer taken during quota hunts must be checked at the refuge check station on same day killed. Hunters must leave the hunt area once they have killed a deer.

Waterfowl, small game and archery deer hunting is prohibited during refuge quota muzzleloader and gun deer hunts.

A hunter orange vest and hat is required while hunting during refuge quota hunts.

Only portable deer stands may be used. Deer stands must have the owner's name, address and phone number clearly printed on the stand. Stands may be erected two days before the beginning of the refuge archery season and removed the last day of the state archery season.

Only temporary waterfowl hunting blinds are allowed. Blinds and decoys must be removed daily.

Beaver, feral hogs, nutria, raccoon and coyote may be taken incidental to any refuge hunt with weapons legal for that hunt until the daily bag limit of game is taken. Hunting is permitted during daylight hours only. Hunting any wildlife other than migratory birds, squirrel and rabbit with dogs is prohibited.

Dogs are only allowed to locate, point, and retrieve when hunting for migratory game birds.

Hunting with dogs for migratory birds is permitted during migratory bird seasons. Hunting with dogs for rabbit and squirrel is permitted during rabbit and squirrel seasons beginning January 17, 2006.

Up to two dogs per hunting party are permitted for squirrel hunting. All dogs must be collared with owner's name and phone number. Use of dogs to trail wounded deer is prohibited.

## Commercial Activities

Refuge regulations require anyone engaged in a commercial activity (fishing, hunting, etc.) to first obtain a refuge special use permit. Anyone planning to pursue a commercial activity on refuge land, lakes, bayous or waters are advised to contact the refuge manager for

information on permitted commercial activities and special use permits.

## Sport Fishing Regulations

Fishing is permitted on the refuge throughout the year during legal sunrise and legal sunset only.

Anglers may harvest any fish species on the refuge that is permitted by State regulations. State fish bag and size limits apply.

Appropriate State licenses and State recreational gear licenses are required.

Use of gear or equipment other than hook and line to catch bait fish is prohibited.

Recreational crawfishing is permitted on the refuge with either traps or nets from March 15 - July 31, 2006. The harvest limit is 100 pounds per vehicle or boat per day. All traps and nets must be attended at all times and may not be left on the refuge overnight. Parking is only permitted in designated parking areas. No parking is permitted along the refuge road.

The minimum mesh size for crawfish traps must be a hexagon of three-quarters by eleven-sixteenths of one inch (measured from wire to wire, not including coating). A State recreational gear license is required in addition to other State licensing requirements to harvest crawfish with traps on the refuge. Traps (including all traps in possession of the angler) must be marked with a waterproof tag with the name and State recreational gear license number of the fisherman legibly printed on the tag. Only 20 traps per angler are permitted on the refuge at the same time.

Crawfish nets are permitted on the refuge and require no additional licenses other than a basic State fishing license.

No slat traps or hoop nets are permitted on the refuge.

The use of trotlines and yo-yos is permitted. The ends of trotlines must consist of a length of cotton line that extends from the points of attachment into the water. Yo-yos must be attended (within sight) at all times.

Boats may not be left on the refuge overnight.

Only electric or non-motorized boats are permitted.

Possession of cleaned or processed fish on the refuge is prohibited.

No harvest of frogs or turtles is permitted on the refuge.

## Prohibited Activities

The following activities are prohibited on Cat Island National Wildlife Refuge:

- Taking wildlife or plants or parts thereof (including cutting trees or brush)
  - Use or possession of alcoholic beverages while hunting or operating an ATV
  - Littering
  - Camping /overnight parking
  - Discharge of a firearm, except when hunting
  - Baiting or hunting over bait or salt
  - Hunting within 150 feet of any designated road, ATV or hiking trail, or designated public facility, such as kiosks
  - The use of dogs to trail wounded deer or hogs
  - Possession or use of non-biodegradable flagging tape
  - Trapping
  - Horses or mules
  - Possession of saws, saw blades, and/or machetes
  - Fires
  - Spot-lighting - artificial light may not be used to locate wildlife
  - Man-drives for deer or feral hogs
  - Searching for or removing any object of antiquity including arrowheads, pottery or other artifacts
  - Blocking gates or roadways with vehicles or ATVs
  - Driving a nail, spike or other metal object into a tree, or hunting from any tree in which such an object has been driven
  - Using climbing spikes
  - Parking along roads or in areas that are not designated as parking areas
  - Boat launching by trailer from all refuge roads and parking lots
- Accessing the refuge by boat from the Mississippi River